

# Mac OS - connect to TAFE NSW Wi-Fi

- 1** Click the **wireless icon** in the top right-hand corner of your screen.

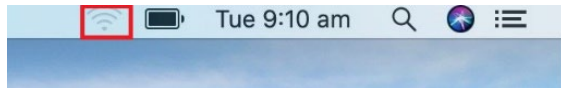

- 2** Click **TAFENSW**.



- 3** Type your **TAFE NSW email** and **password**.

e.g.  
**firstname.lastname3@studytafensw.edu.au**  
 (student)  
**firstname.lastname@tafensw.edu.au**  
 (staff)

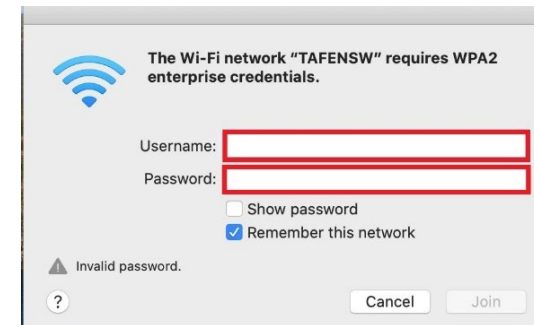

- 4** Click **Remember this Network** to tick the box.

Click **Join**.



- 5** Click **Continue** to verify certificate.

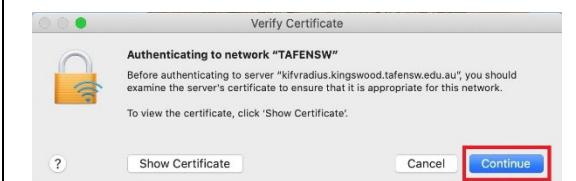

- 6** If asked, use **touch ID** or enter your **device password**.

This will allow changes to your Certificate Trust Settings.



- 7** Click the **wireless icon** again, and **Open Network Preferences**.

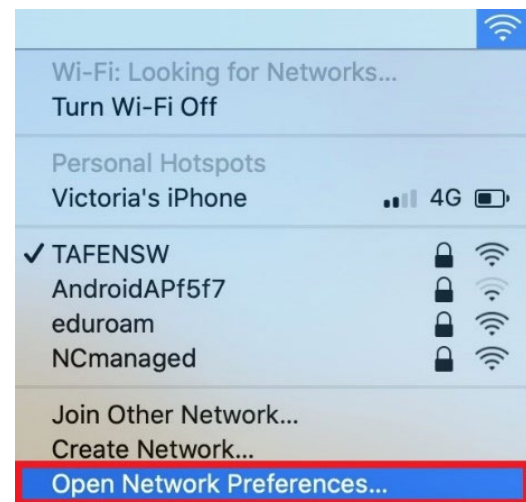

- 8** Click **Advanced**.

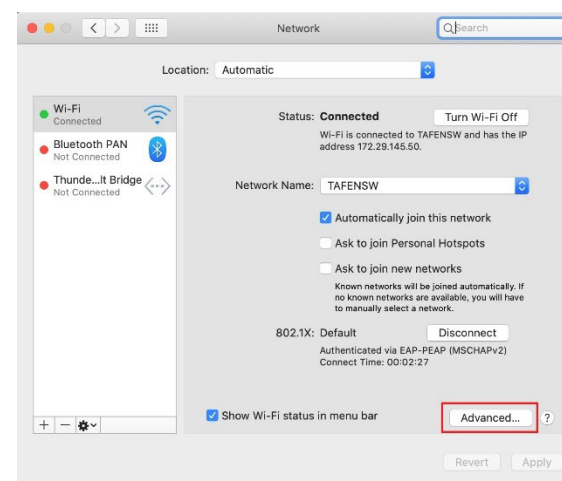

- 9** Click the **Proxies** tab, and tick **Auto Proxy Discovery**.

Click **OK** to close window.

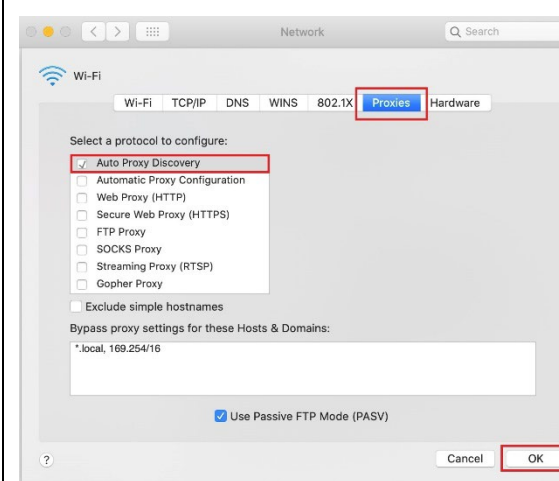

- 10** You should now be connected to the TAFENSW Wi-Fi network.

To test this has worked, open your browser and type a search word.

Your search results should appear soon.

# Mac OS - more help

If you have followed our instructions but you still cannot connect to the Wi-Fi, try one or more of these:

## Forget the network

This may help when you have changed your password, or if the Wi-Fi connection is not working after you have followed our instructions.

1. Click on the **Wi-Fi** icon, and choose **Open Network Preferences**

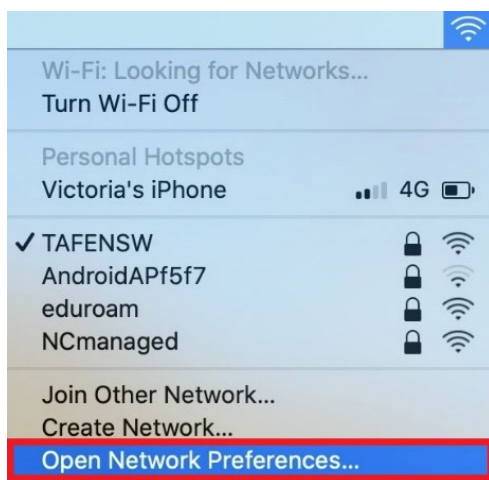

2. Go to **Advanced**. On the **Wi-Fi tab**, select **TAFENSW** from the list.

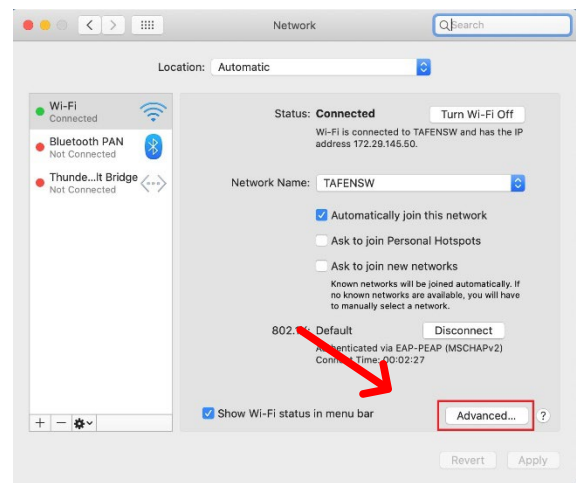

3. click on the **minus (-)** button, then **OK**.

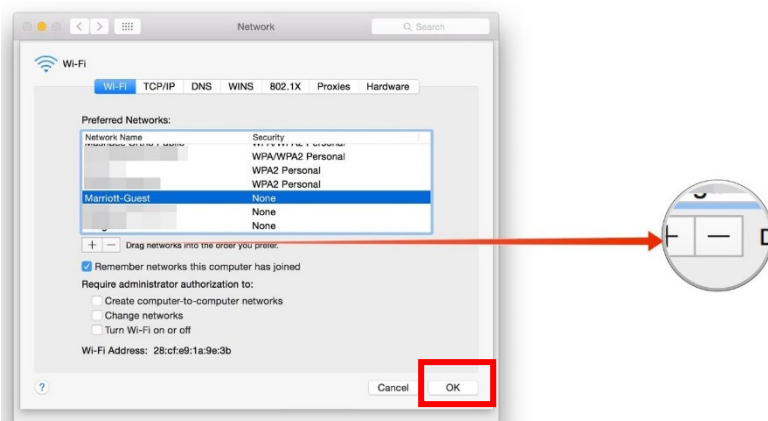

4. If you have iCloud Keychain active, the Mac will warn you that removing it will keep **any** devices connected to the iCloud Keychain from remembering it.

Click **Remove**.

## Still not working?

Get in touch with your local Library staff who may be able to assist you [tafensw.libguides.com/contacts](https://tafensw.libguides.com/contacts), or try our *Support and FAQs* at [tafensw.libguides.com/wifisupport](https://tafensw.libguides.com/wifisupport).